

16mm Rotary Potentiometers

KLS4-WH 48 Series

Mechanical specifications:

Total rotation angle: $300^{\circ} \pm 5^{\circ}$
 Rotation torque: $2 \sim 20 \text{mN.m}$ ($20 \sim 200 \text{gf.cm}$)
 Shaft support strength: 6Kgf.cm
 Push pull strength: 60N
 Rotary life: 0000 cycles
 Click position: Center decenter 0, 20, 40, position clicks

Electrical specifications:

Total resistance: $5 \text{K}\Omega \sim 2 \text{M}\Omega$
 Resistance taper: A, B, C
 Resistance tolerance: $\pm 20\%$
 Rotational noise: $\leq 47 \text{mV}$
 Residual resistance: $R \geq 250 \text{K}\Omega$ 0.1% max. of total resistance
 $250 \text{K}\Omega > R > 10 \text{K}\Omega$ 20 Ω max
 $10 \text{K}\Omega \geq R$ 10 Ω max
 Tracking error: 0 ~ -40dB 3 dB
 Rated wattage: Curve B: 0.125W; Other than B: 0.063 W
 Max. operating voltage: Curve B: 200 V; Other than B: 150 V
 Dielectric: AC500V, 1 minute
 Insulation resistance: More than $100 \text{M}\Omega$ at DC500V



18T	L	15	20	25	30	F	L	15	20	25	30
	l	7	12	12	12	F	7	12	12	12	

ORDER INFORMATION

Product NO.: KLS4-WH 48- A- - 8T-B 03-L 5

Pos. NO. _____
 6mm Rotary Potentiometers _____
 Shaft Type: 8T, F _____
 Shaft length: L 5, L20, L25, L30
 Value: 03- 0000 Ω
 Resistance change characteristics:
 A=logarithmic
 B=linear
 C=exponential

16mm Rotary Potentiometers

WH 48- A-

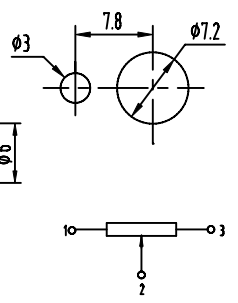
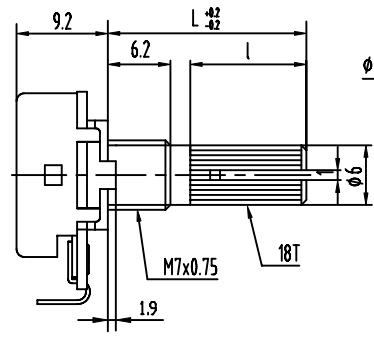
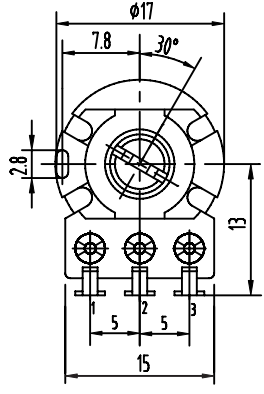
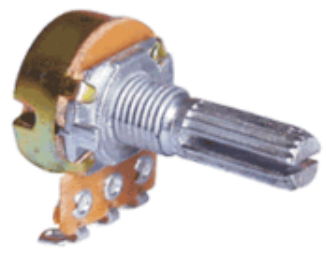

WH 48- A-2

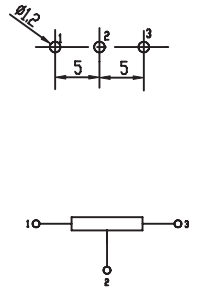
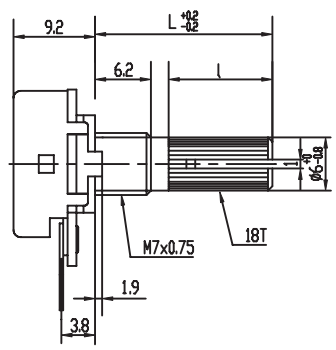
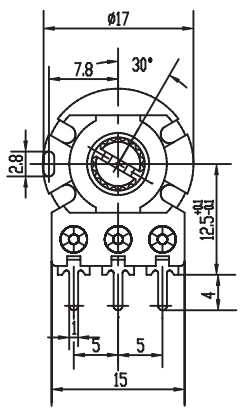

WH 48- A-3

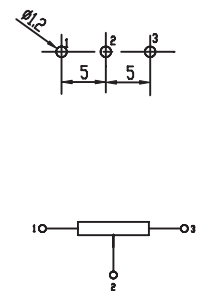
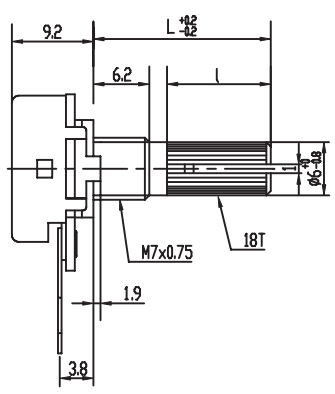
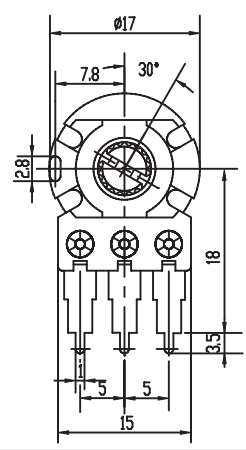

ORDER INFORMATION

Product NO.: KLS4-WH 48- A- - 8T-B 03-L 5

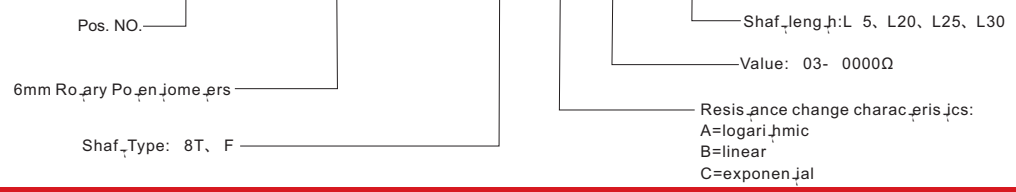

All specification & dimensions are subject to change, please call your nearest KLS sales representative for update information



16mm Rotary Potentiometers

WH 48- A-4

WH 48- A-5

WH 48- A-2S- 8T

ORDER INFORMATION

Product NO.: KLS4-WH 48- A- - 8T-B 03-L 5

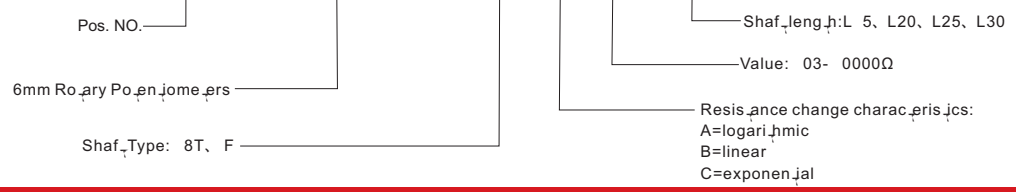

All specification & dimensions are subject to change, please call your nearest KLS sales representative for update information

16mm Rotary Potentiometers

H 48- B-

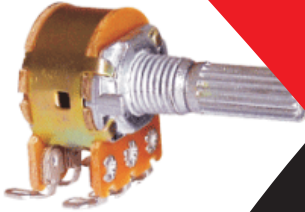

8- B-φ4FWH3 48 B

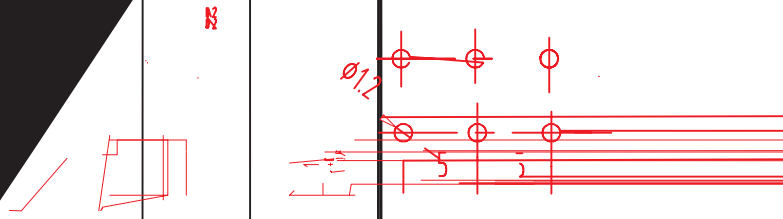

48 B

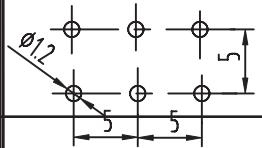
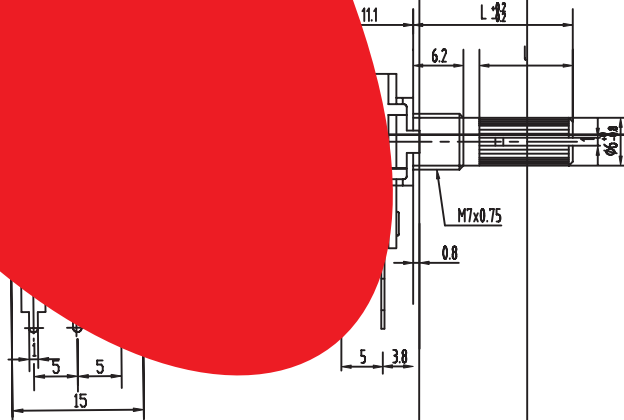



16mm Rotary Potentiometers

WH 48- B-4

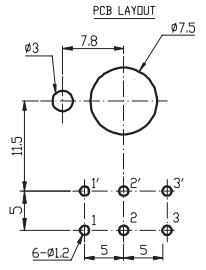
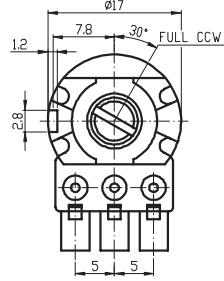
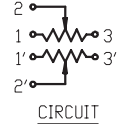
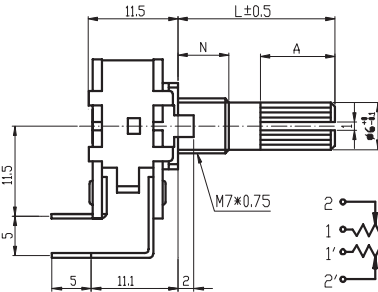
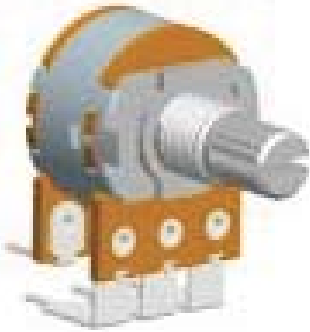

WH 48- B-4J

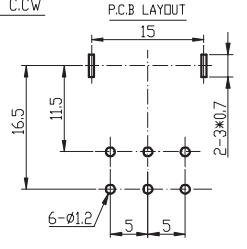
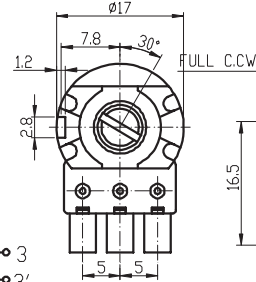
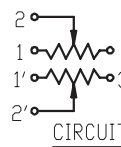
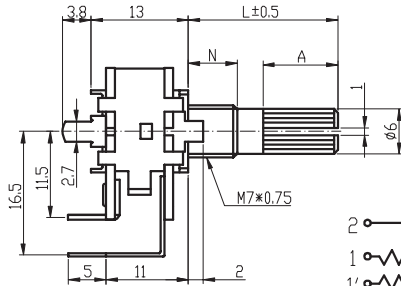
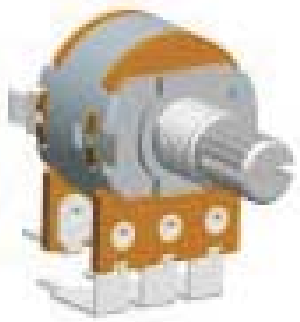

WH 48- B-5

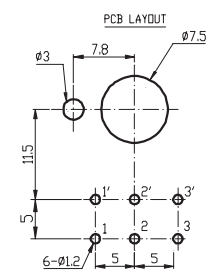
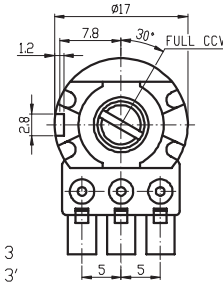
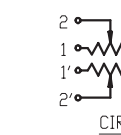
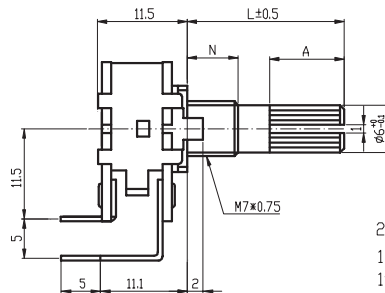

ORDER INFORMATION

Product NO.: KLS4-WH 48- A- - 8T-B 03-L 5

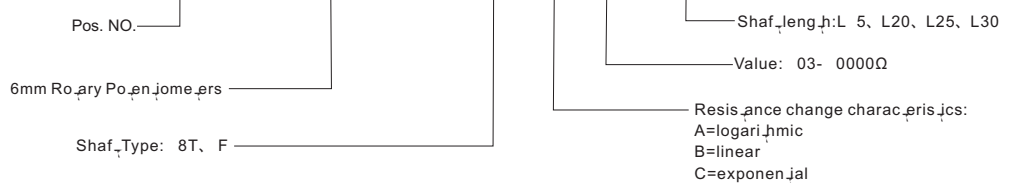

All specification & dimensions are subject to change, please call your nearest KLS sales representative for update information

Potentiometer



16mm Rotary Potentiometers

WH 48- B-2J

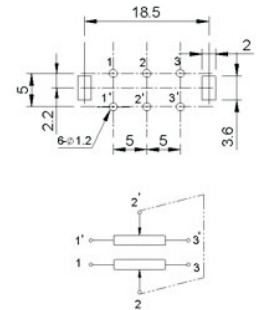
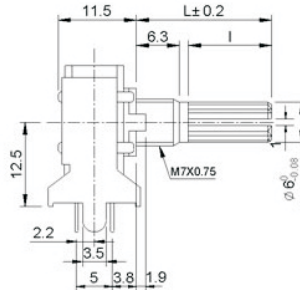
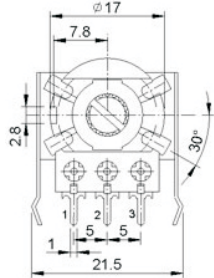
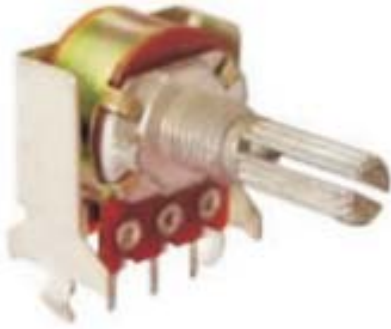

WH 48-2B-2

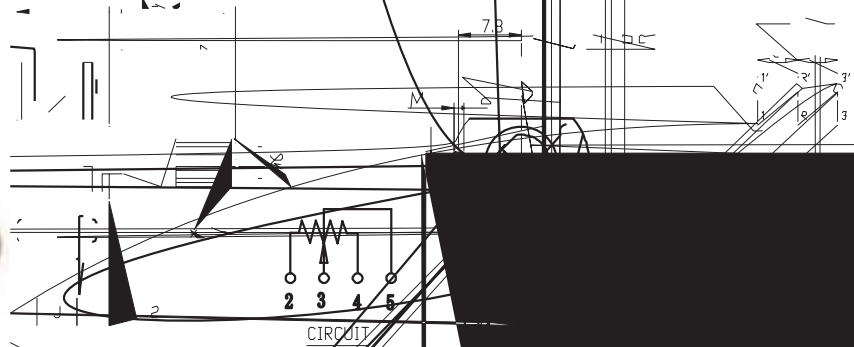
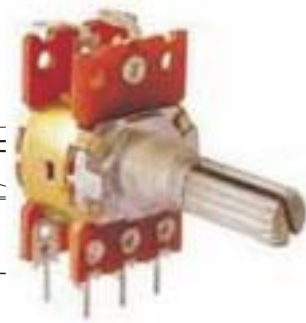

WH 48-3A-2

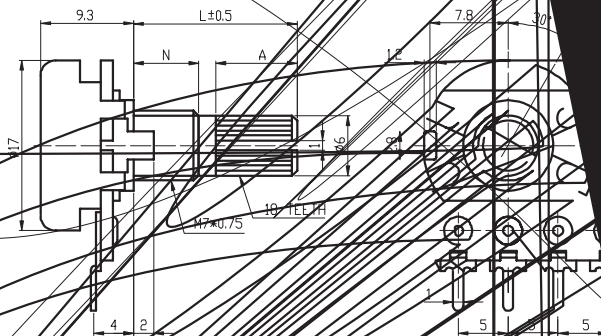
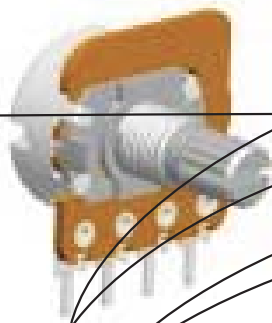

ORDER INFORMATION

Product_NO : KLS4-WH 48- A- - 8T-B 03-L 5

Pos. NO.

16mm Rotary Potentiometers

Shaft_Type: 8T, F

Resis.
A=loga
B=linea
C=expo

All specification & dimensions are subject to change, please call your nearest KLS sales representative for update information.

16mm Rotary Potentiometers

WH 48-3B-2

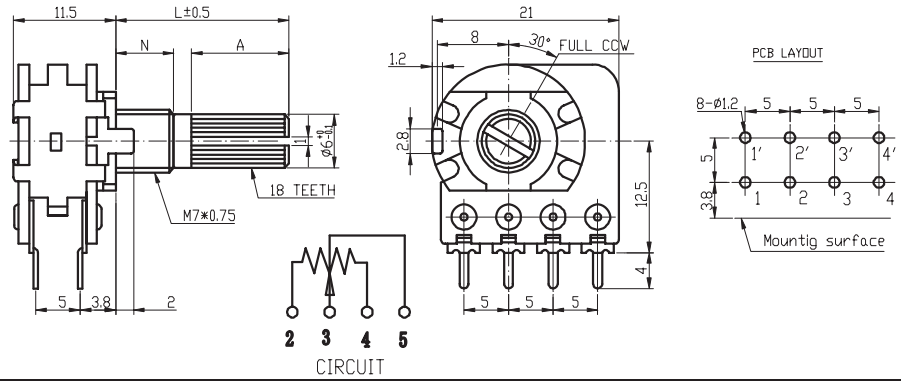

WH 48-3B-2J

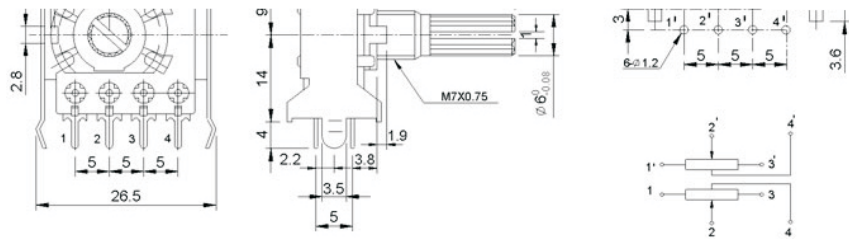

WH 48-4B

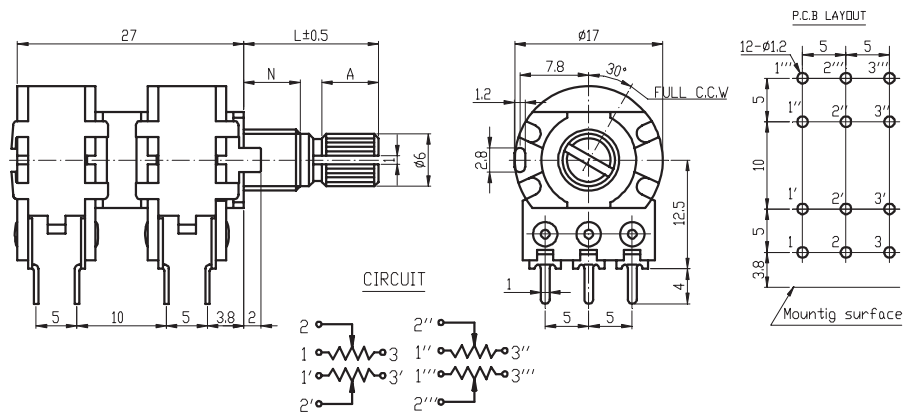

ORDER INFORMATION

Product NO.: KLS4-WH 48- A- - 8T-B 03-L 5

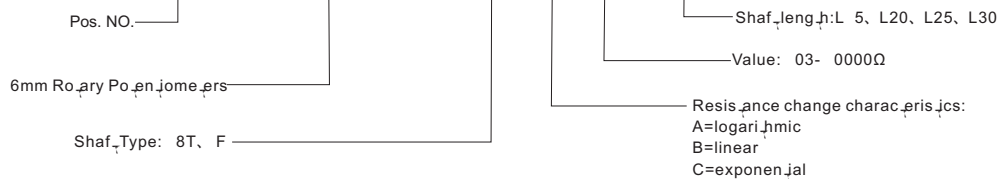

16mm Rotary Potentiometers

WH 48-6B6

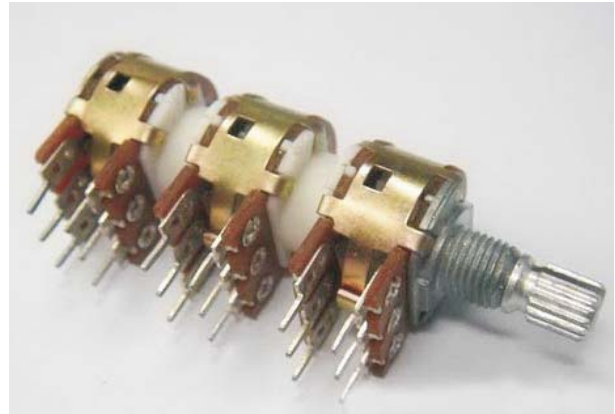

VI

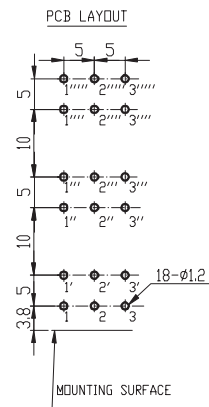
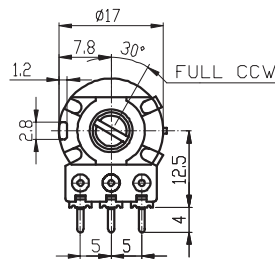
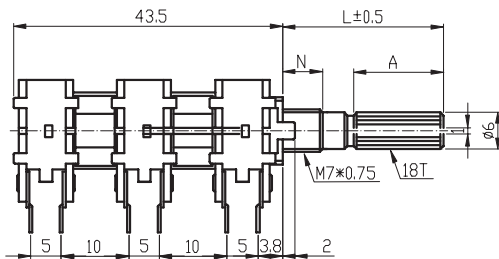

CIRCUIT

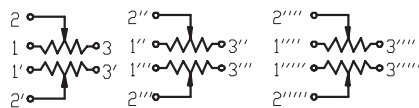

ORDER INFORMATION

Product NO.: KLS4-WH 48- A- - 8T-B 03-L 5

